

LEVEL 2  
 - CPC ADMIN SUITE (4000 SF)

LEVEL 1  
 - MULTIPURPOSE ROOM (SUBDIVIDE INTO (3) CLASS-ROOMS) (6000 SF)  
 - SPECIAL NEEDS SUITE (3) LARGE CLASSROOMS + SUPPORTS SPACES)(3,700 SF)  
 - COMMERCIAL KITCHEN  
 - STORAGE  
 - EXPANSIVE LOBBY FOR GATHERINGS

CPC RENOVATION  
 - (2) NEW CLASSROOMS  
 - ADDED HOSPITALITY SPACE  
 - OUTDOOR CONNECTION TO NEW BUILDING

NEW BUILDING SF: 24,500  
 RENOVATION SF: 3,000  
 ADDED PARKING  
 NEW PARKING SPACES: 17

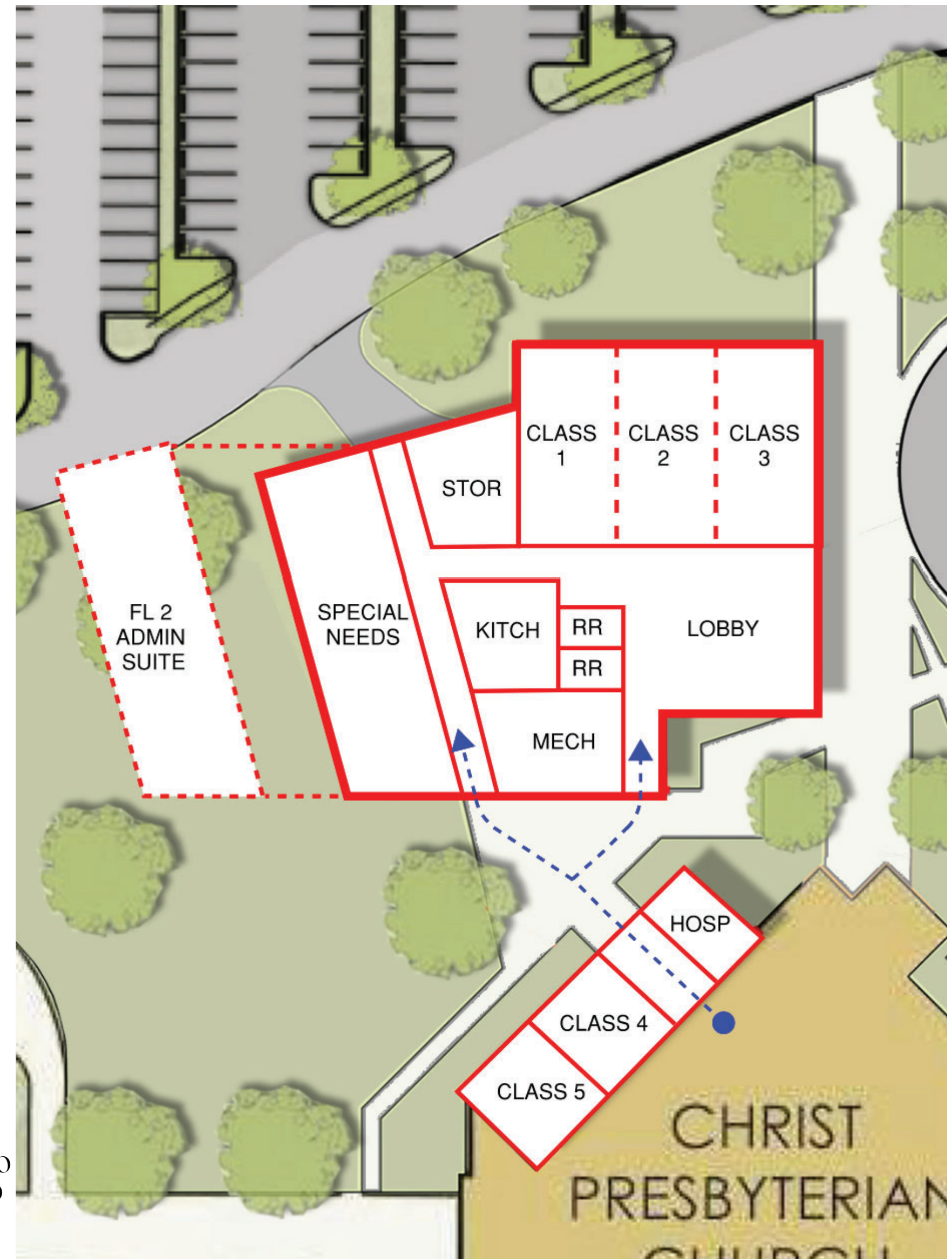



*AK*Consulting

Adult / Event Rendering

 **CHRIST**  
PRESBYTERIAN CHURCH

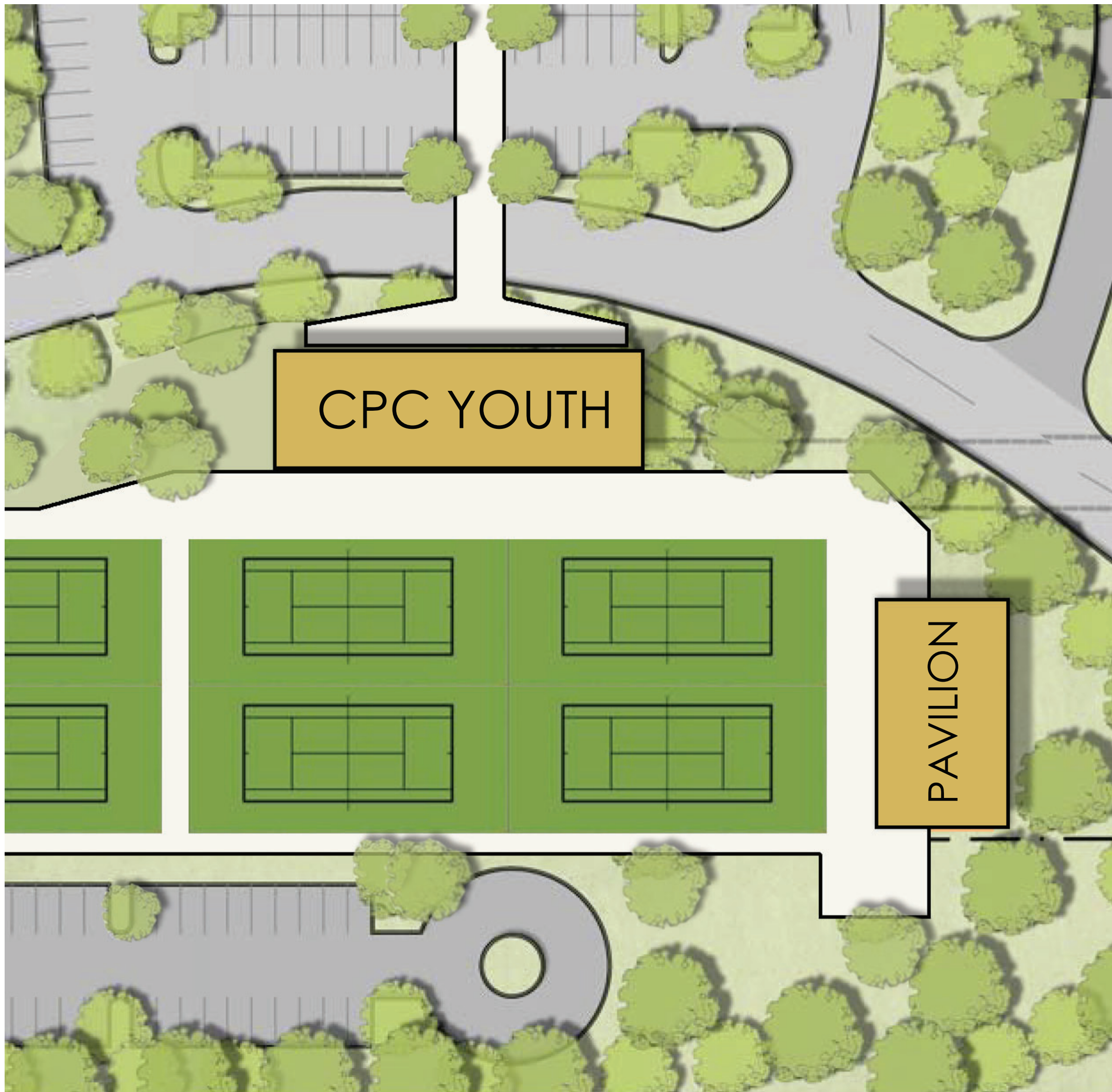

**LEVEL 2**

- 11 YOUTH MEETING ROOMS
- 2 DEDICATED YOUTH OFFICES
- STORAGE



**LEVEL 1  
(ON GRADE WITH SANCTUARY)**

- 3 YOUTH LARGE MEETING ROOMS
- COMMERCIAL KITCHEN
- EXPANSIVE LOBBY
- STORAGE

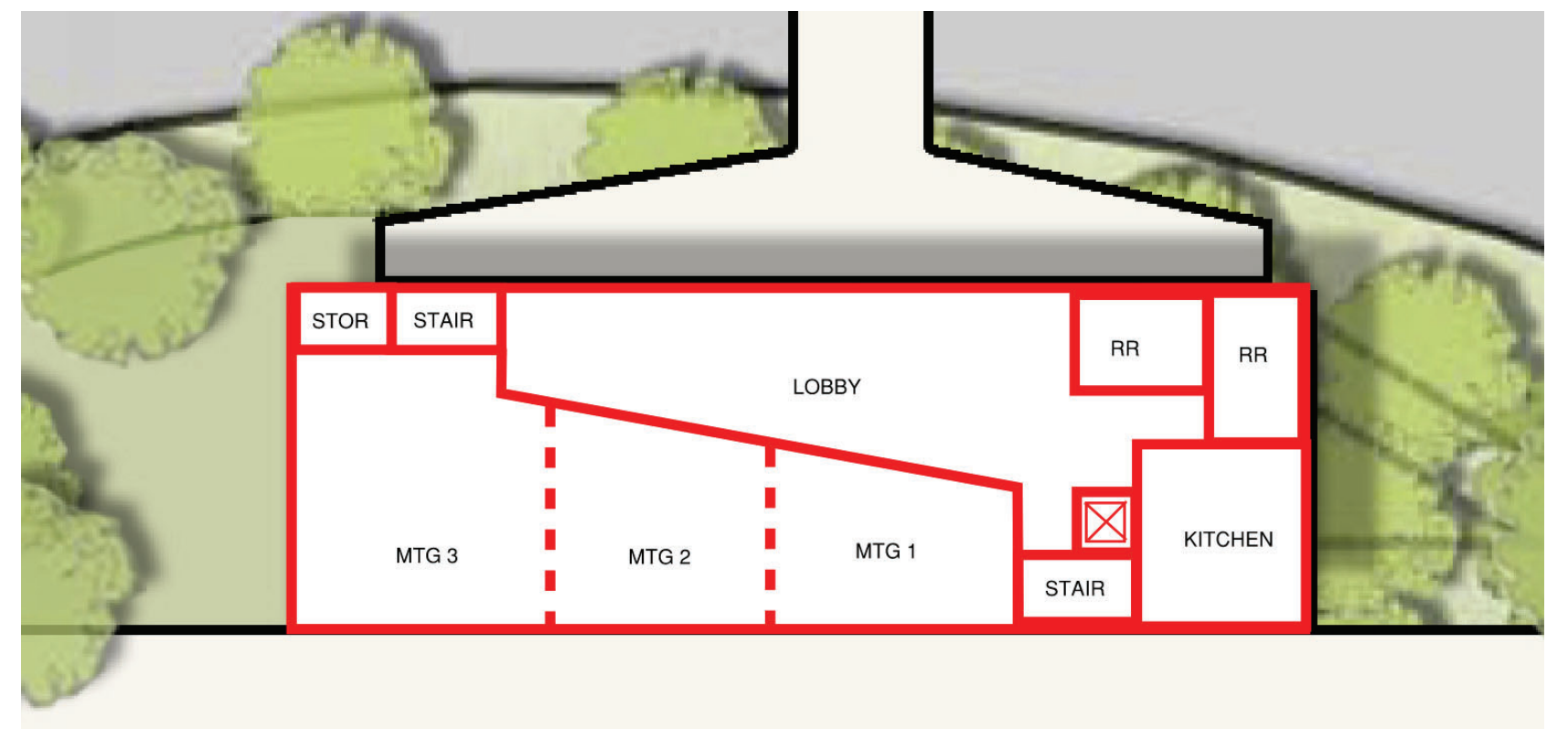

**LEVEL 0  
(ON GRADE WITH TENNIS)**

- YOUTH LIVING ROOM / GAME ROOM
- CHANGING ROOMS
- CONCESSIONS
- STORAGE

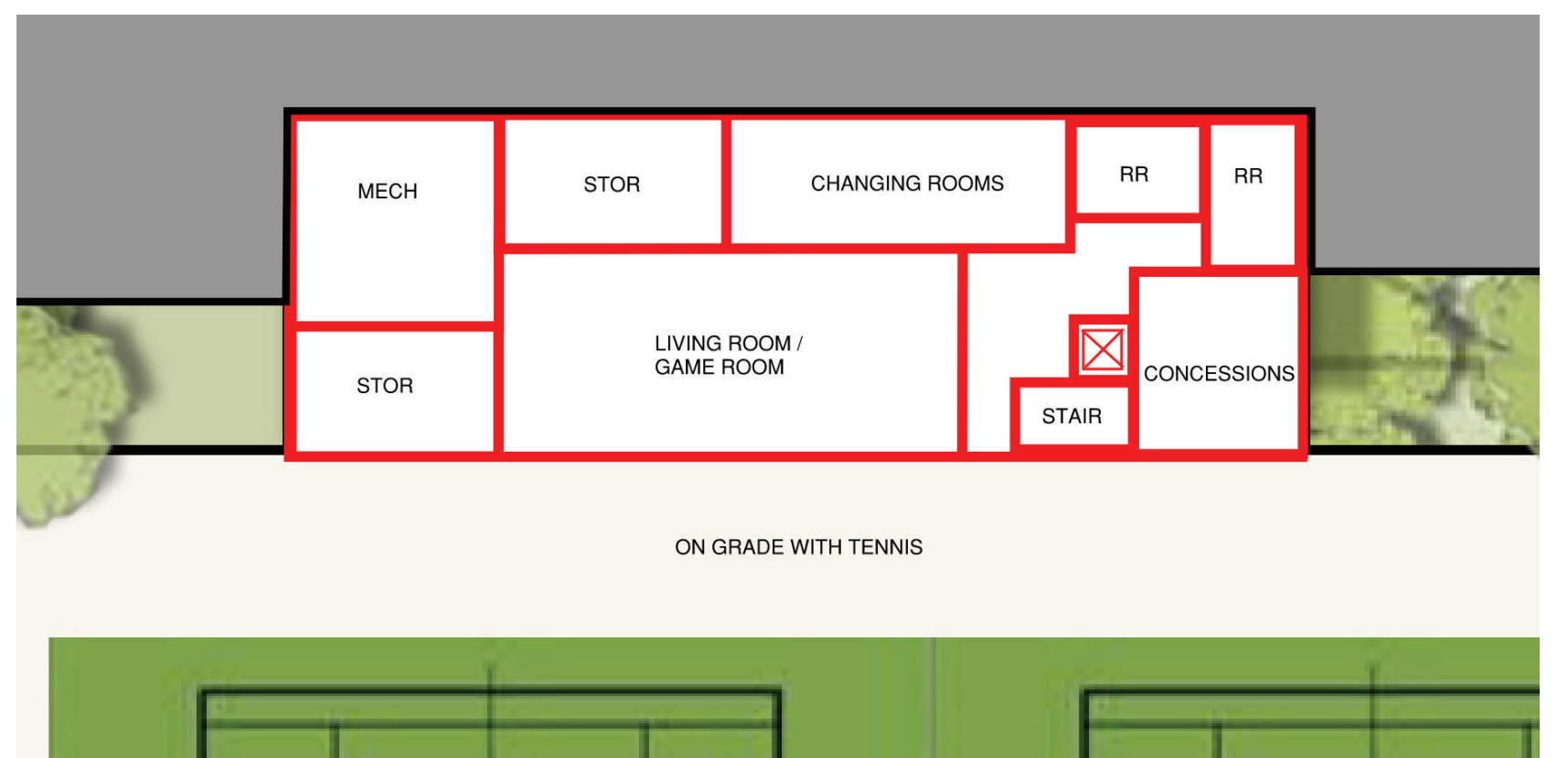

BUILDING SF: 15,580  
 PAVILION SF: 5,000  
 ADDED PARKING SPACES: 40



AK Consulting

Youth Rendering (Street)



